



TO LET

Oldhams Meadow, Aylesbury
£1,050 pcm + security deposit

Attractive one bedroom maisonette - close to town and trains.

- Ground floor maisonette
- 1 double bedroom
- Good size reception room
- Bathroom with bath & shower
- One parking space
- Energy Rating : D
- Council Tax Band B
- Unfurnished
- Own garden
- Near town and trains



£1,050 pcm +
security deposit

Oldhams Meadow,
Aylesbury,
Bucks
HP20 2UU

>> Key Features

- Ground floor maisonette
- 1 double bedroom
- Good size reception room
- Bathroom with bath & shower
- Energy Rating : D
- Council Tax Band B
- Unfurnished
- Own garden
- One parking space
- Near town and trains

Not far from Aylesbury town centre and train station, this attractive one bedroom ground floor maisonette, comes to the market on an unfurnished basis, available 21st December 2024. Accommodation comprises own front door to entrance hall, living room with doors to own private garden, good size fitted kitchen with appliances, one double bedroom, bathroom with bath and shower over. Electric heating. Double glazing. Energy efficiency rating grade D. Council tax band B. One allocated parking space. MANAGED BY AN ARLA PROPERTYMARK MEMBER AGENT WITH FULL CLIENT MONEY PROTECTION. SORRY NO PETS.

IMPORTANT - The holding deposit is equivalent to one week of the final agreed rent. The security deposit is equivalent to five weeks of the final agreed rent. Tenants pay all utility bills and council tax. Tenants arrange their own broadband and must make the necessary enquiries as to the speed and quality of broadband and the strength of the mobile phone signal where this property is situated. A broadband and mobile signal coverage checker can be found on the website of Ofcom.



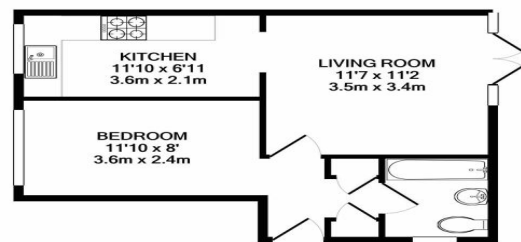

TOTAL APPROX. FLOOR AREA 384 SQ.FT. (35.7 SQ.M.)
 Whilst every attempt has been made to ensure the accuracy of the floor plan contained here, measurements of doors, windows, rooms and any other items are approximate and no responsibility is taken for any error, omission, or mis-statement. This plan is for illustrative purposes only and should be used as such by any prospective purchaser. The services, systems and appliances shown have not been tested and no guarantee as to their operability or efficiency can be given.
 Made with Metropix ©2021

Directions



Image
Not
Available



Image
Not
Available

Our Fees

1) Lost keys and/or other security devices - Tenants are liable to the actual cost of replacing any lost key(s) or other security device(s). If the loss results in locks needing to be changed, the actual costs of a locksmith, new lock and replacement keys for the tenant, landlord any other persons requiring keys will be charged to the tenant. If extra costs are incurred there will be a charge of £15 per hour (Inc. VAT) for the time taken replacing lost key(s) or other security device(s).

THE PROPERTY MISDESCRIPTIONS ACT 1991: Any areas, measurements or distances are approximate. Land measurements are provided by the vendor and buyers are advised to obtain verification from their solicitor. The text, photographs and plans are for guidance only and are not necessarily comprehensive. Items shown in the property photographs are not included unless specifically mentioned within the sales particulars although they may be available by separate negotiation. Paul Kingham Lettings cannot verify that the fixtures and fittings, equipment or services are in working order or fit for the purpose and buyers are advised to obtain verification from their solicitor. The tenure of a property is based upon information supplied by the seller and buyers are advised to obtain verification from their solicitor.